

# USER MANUAL



## BEAM MOVING HEAD LIGHT

**Please read and keep this manual carefully for further use!**

Thank you for buying our professional Beam moving head.

This user manual includes important information for installation and operation, so please read this user manual carefully before installation and operation, and keep this user manual well for further use.

In order to install , operate, and maintain the lighting safety and correctly. We suggest that the installation and operation should be done by the verified technician and follow the instruction strictly.

### **Spare part includes:**

Name	QTY	Unit
Fixture	1	PC
User manual	1	PC
Power cable	1	PC
Bracket	2	PCS
DMX signal cable	1	PC
Light hook	2	PCS
Safety wire	1	PC

Please check carefully that there is no damage caused by transportation. Should there be any, consult your local dealer.

### **Cautions**

**Before delivery, this device has passed strict inspection, Please follow the user manual strictly for operation, if this fixture is damaged by improper operation and mistake, the fixture will be out of warranty, and manufacture or dealer won't be responsible for it. In case of any technology change in this manual,we won't advise in further .**

#### **CAUTION!**



**Keep this device away from rain and moisture!**



**Unplug mains lead before opening the housing!**



**Warning!**  
**Damages caused by the disregard of this user manual are not subject to warranty. The dealer will not accept liability for any resulting defects or problems.**

## Installation



### **CAUTION!**

Please consider the GB7000.15/EN60598-2-17 and the other respective national norms during The installation. The installation must only be carried out by a qualified person.

- ▶ This fixture is not suitable for direct installation on combustible material surface, please keep the fixture surface at least 0.5m from any combustible material.
- ▶ If you use the quick lock cam in hanging up the fixture, please make sure the quick lock fasteners turned in the quick lock holes correctly.
- ▶ The applicable temperature for the fixture is between -25°C to 45°C. Do not use the lighting under or above this temperature range.
- ▶ The truss for hanging the fixture should be able to hold 10 times weight of this fixture and no deformation after 1 hour hang.
- ▶ Please don't stand under the fixture when install, uninstall, move or repair the fixture.
- ▶ Please ensure the light is connected correctly and invite professional technician to check and confirm the electrical data before installation.
- ▶ Please invite professional technician to check the fixture and installation each year.

## Rigging:

**Clamp**

**Bracket**

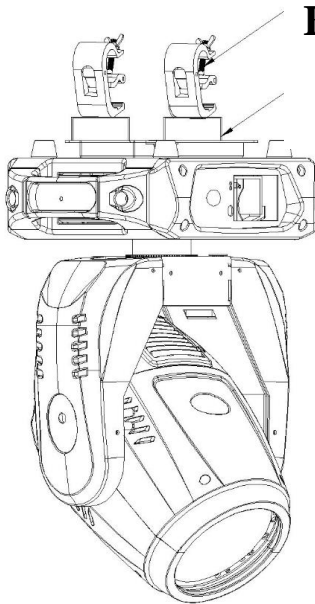

**Safety rope**

**Quick lock**

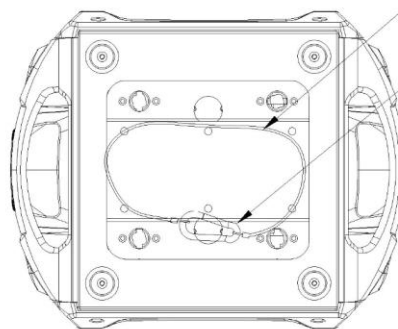

Insert the quick-lock fasteners of the first holder into the respective holes on the bottom of the device. Tighten the quick-lock fasteners fully clockwise.

Fix the clamp on truss or other fixture bracket.

Pull the safety rope through the holes on the bottom of the base and fasten it on the truss or other fixing point.

Note: This step is quite important to ensure that fixture will not drop down for the clamp damage.

## Product specification

1. Voltage: 100-240V, 50/60HZ;
2. Power Consumption: 320W;
3. Lamp: Mingzhe 250W
4. Average lifetime: 2000 hours; Color Temp: 8000K;
5. Pan: 540° (16bit) electronic error correction;
6. Tilt: 270° (16bit) electronic error correction;
7. Color wheel: 14 colors + open
8. Gobo wheel: 13 gobos + open; including 3 mirror gobos
9. Prism 1: 8-facet + 16-facet, prism 2: 16-facet
10. Frost and 6-color wheel effect, electronic focus
11. Electrical dimming: 0%~100%; support strobe at various speeds, strobe color marco
12. Beam angle: 2°; lumen: 103000lux at 15m, with RDM, strobe: 1-25HZ
13. Over-heat protection; Display: LCD
14. IP rate: IP20;
15. Product size: 340\*255\*515mm;
16. Outer carton size: 440\*410\*540mm;
17. N.W: 14.5KG;

## Display and operation

Touch button	Function
Up	Option, Edit
Left	Option, Edit
Right	Option, Edit
OK	Enter to edit or confirm

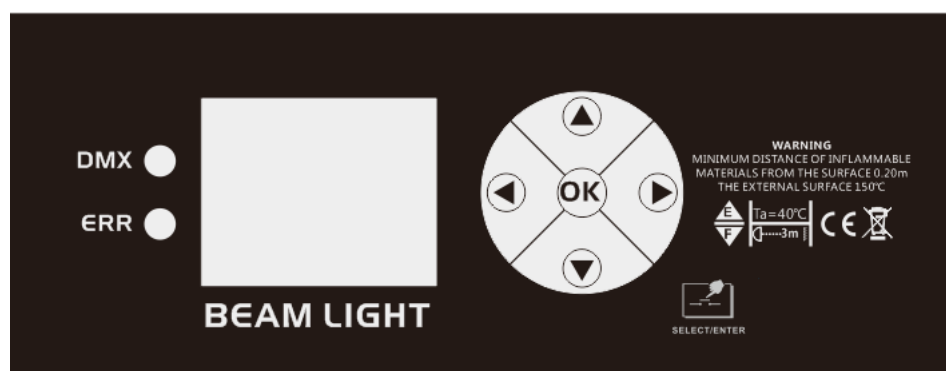

Sub-menu operation mainly by touch, if using by Roller, operation instruction as below

<Up> : turn up; <Down> : turn down; <OK> : enter or confirm

## **Menu operation**

MAIL		
MENU	----Setting	<ul style="list-style-type: none"> <li>----running mode</li> <li>----DMX setting</li> <li>----DMX channel mode</li> <li>----sound sensitivity adjustment -2/+2</li> <li>----X reverse</li> <li>----Y reverse</li> <li>----Y.X exchange</li> <li>---- XY encode</li> <li>---- RDM</li> <li>----DMX lost</li> <li>----display protection</li> <li>----lamp ON</li> <li>----factory default</li> </ul>
	---manual	
	---system	<ul style="list-style-type: none"> <li>----DMX channel value monitor</li> <li>----system error record</li> <li>----software version</li> <li>----date</li> <li>----turn on time</li> </ul>
	---senior	<ul style="list-style-type: none"> <li>----sensor monitoring</li> <li>----reset correction</li> <li>----gobo, color correction</li> </ul>
	---reset	----all motors reset
	--lamp	
	--English/Chinese	
	--display reverse	

## **Manual operation**

Press “OK” button to edit, choose digit at hundred place, choose UP or DOWN button to change the value, press OK to confirm.

## **System info**

Option	Details
software version	the current software version
DMX channel value	enter the sub-menu, show channel value or percentage

system error record	if the ERROR indicator is ON, it means the fixture has operation error, can enter the sub-menu to check and cancel the record
---------------------	---

Error	Details
motor reset failure, serial port error	Driving PCB no feedback. the connection between display PCB and driving PCB has problem, or driving PCB problem
Pan reset error	Pan photo-electrical switch or Pan motor problem
Tilt reset error	Tilt photo-electrical switch or Tilt motor problem
Pan Hall error	Pan Hall error
Tilt Hall error	Tilt Hall error
color wheel reset failure	color wheel hall or color wheel motor problem
gobo wheel reset failure	gobo wheel hall or gobo wheel motor problem
focus reset failure	focus hall or focus motor error
lamp control failure	lamp ON/OFF error, lamp ballast or lamp have problem

## Senior

A password is set up to prevent from wrong operation by unprofessional people. Default password is "\*\*\*\*\*". press "OK" for password verification.

Option	Details
reset	Enter the sub-menu, adjust the Pan/Tilt motor's reset position, the adjustment range is -128~+127, +0 means no adjustment
sensor monitoring	monitor the status of all sensor and Hall switch

## Gobo wheel

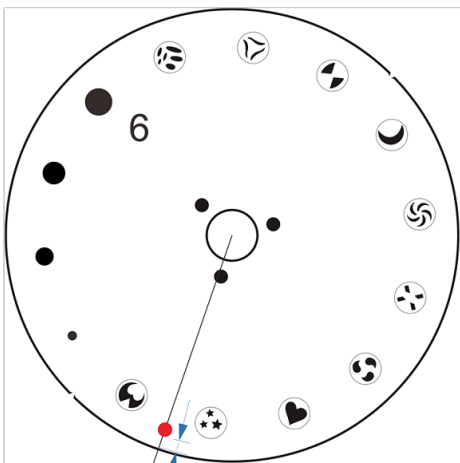

## Color wheel



## Six-color effect

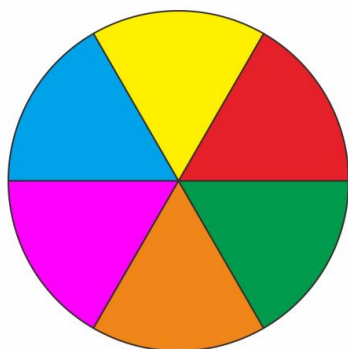

## 16 DMX channel

16CH	Function	Value	Details	Remarks
CH1	gobo wheel	201-255	clockwise gobo flowing slow to fast	
		150-200	anti clockwise gobo flowing fast to slow	
		145-149	color 14+ white	
		140	color 14	
		135	color 13 +color 14	the value is 5N
		130	color 13	
		125	color 12 +color 13	
		120	color 12	
		115	color 11 +color 12	
		110	color 11	
		105	color 10 +color 11	
		100	color 10	
		95	color 9 +color 10	
		90	color 9	
		85	color 8 +color 9	
		80	color 8	
		75	color 7 +color 8	
		70	color 7	
		65	color 6 +color 7	
		60	color 6	
		55	color 5 +color 6	
		50	color 5	
		45	color 4 +color 5	
		40	color 4	
		35	color 3 +color 4	
		30	color 3	
		25	color 2 +color 3	
		20	color 2	
		15	color 1 +color 2	
		10	color 1	

		5	white +color 1	
		0	white	
<b>CH2</b>	strobe	252-255	shutter open	controlled by dimmer channel
		213-251	random strobe slow to fast	
		208-212	shutter open	controlled by dimmer channel
		108-207	Pulse strobe slow to fast	
		104-107	shutter open	controlled by dimmer channel
		4-103	strobe slow to fast	
		0-3	shutter off	
<b>CH3</b>	dimmer	0-255	dimmer 0-100%	
	<b>CH4</b>	gobo wheel	201-255	gobo flowing slow to fast (anticlockwise)
140-200			gobo flowing fast to slow(clockwise)	
135-139			gobo 14 shake slow to fast	
130-134			gobo 13 shake slow to fast	
			.....	
75-79			gobo 2 shake slow to fast	
70-74			gobo 1 shake slow to fast	
65-69			gobo 14	
60-64			gobo 13	
55-59			gobo 12	
50-54			gobo 11	
45-49			gobo 10	
40-44			gobo 9	
35-39			gobo 8	
30-34			gobo 7	
25-29			gobo 6	
20-24			gobo 5	
15-19			gobo 4	
10-14			gobo 3	
5-9			gobo 2	
0-4	gobo 1			
<b>CH5</b>	prism	192-255	prism 1+ prism 2	
		128-191	prism 2	
		064-127	prism 1	
		000-063	no effect	
<b>CH6</b>	prism rotation	193-255	clockwise rotation slow to fast	
		191-192	stop	
		128-190	anticlockwise rotation fast to slow	
		0-127	adjust angle	



<b>CH7</b>	frost and six color effect	192-255	frost	
		128-191	six color effect	
		0-127	no function	
<b>CH8</b>	focus	0-255	focus 0-100%	
<b>CH9</b>	focus fine	0-255	focus fine	
<b>CH10</b>	pan	0-255	0-540 degree	
<b>CH11</b>	pan fine	0-255	0-1.2 degree	
<b>CH12</b>	tilt	0-255	0-270 degree	
<b>CH13</b>	tilt fine	0-255	0-1.2 degree	
<b>CH14</b>	XY speed	0-255	speed fast to slow	
<b>CH15</b>	auto	146-255	no function	
		128-145	random auto	
		0-127	no function	
<b>CH16</b>	lamp control and reset	245-250	all motors reset	lamp ON/OFF after 5 seconds
		220-235	small motors reset	
		210-215	Pan/Tilt reset	
		200-205	lamp on	
		100-105	lamp off	
		0-99	no function	

## DMX-512 connection

Connect the provided XLR cable to the male 3-pin XLR output of your controller and the other side to the female 3-pin XLR input of the light. then connect the DMX signal to the first fixture to the 2<sup>nd</sup> fixture, after all fixtures are connected,

The signal cable should be two - core with screened cable with XLR input and output connectors. Please refer to the diagram below

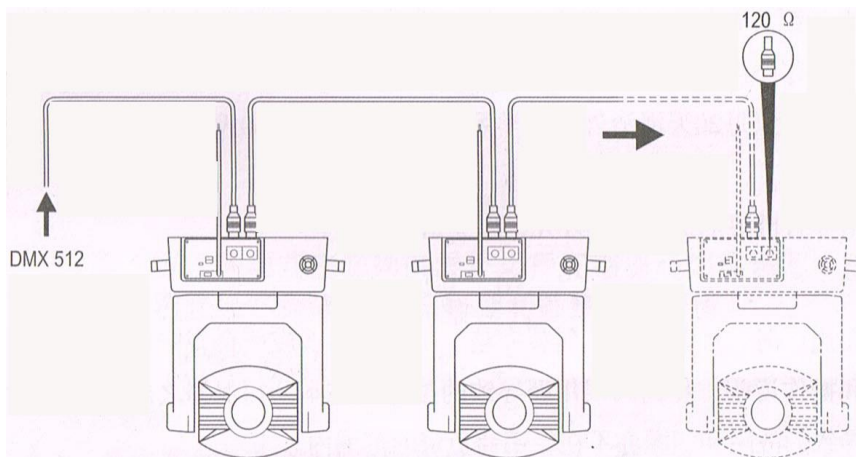

## DMX terminator connection

If there are many lines or lights, it is recommended to use a DMX terminator to prevent DMX signal corruption, the DMX terminator is a simple XLR plug with a 120 Ω resistor connected between pins 2 and 3, which is then plugged into the output XLR socket of the last fixture in the chain.

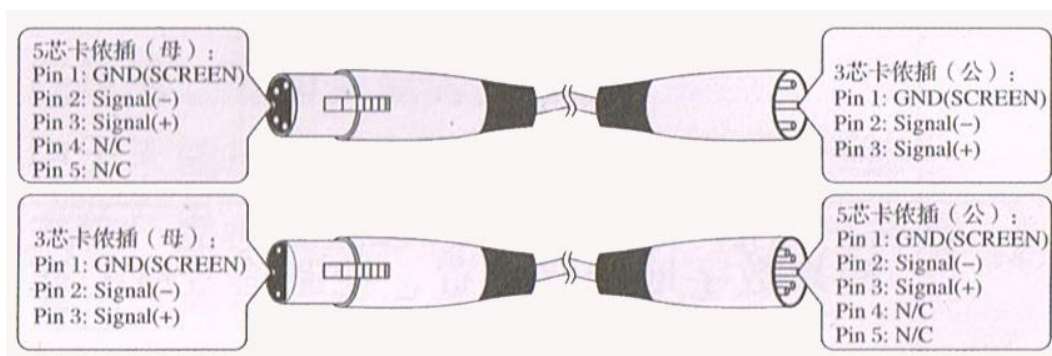

3-Pins connection

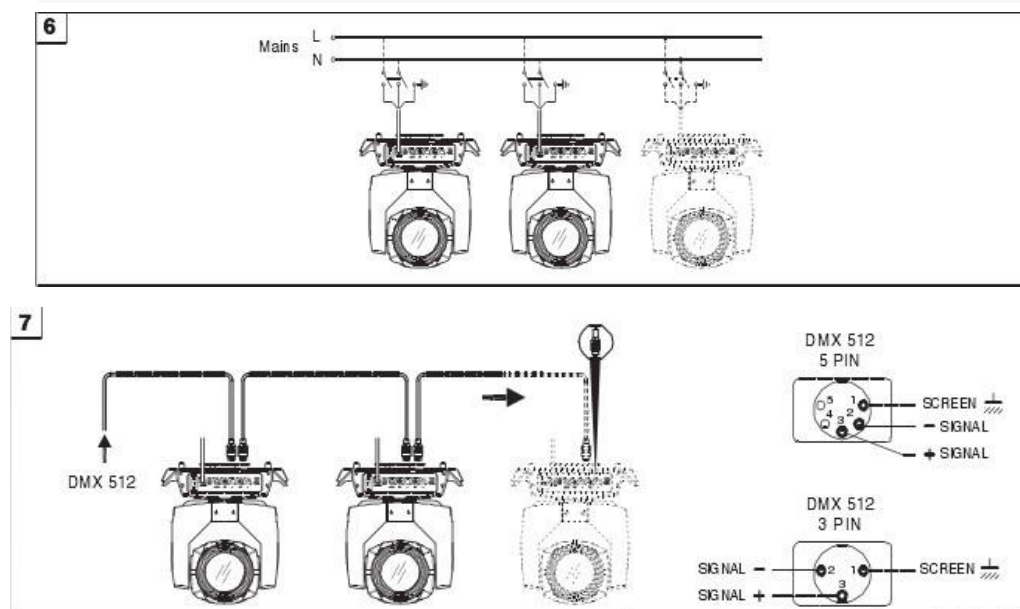

### Cleaning and maintenance

Cleaning should be performed every 15-day period, by using a sponge which is dipped with alcohol, rather than wet cloth or other chemical liquid, to clean the mirror.



#### CAUTION

Cut off power before cleaning and maintenance!

## Attention

Do not see directly light source when open the light, and make sure power off before do any installation or maintenance.

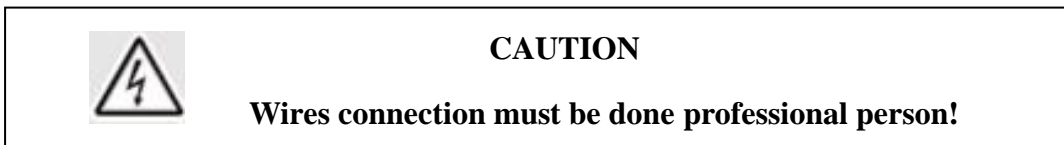
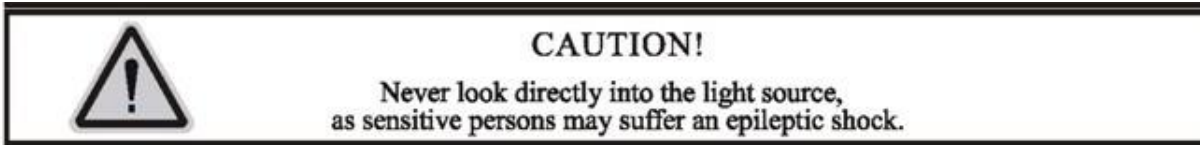

## Cautions

Before delivery, this device has passed strict inspection, Please follow the user manual strictly for operation, if this fixture is damaged by improper operation and mistake, the fixture will be out of warranty, and manufacture or dealer won't be responsible for it. In case of any technology change in this manual, we won't advise in further .

## Common issues instruction

Issues	Solve instruction
No power	Check power's voltage
When power in, output light but the device cannot accept control signal	Check address setting and the control DMX cable connection well or not
The effect have light shadow	Check electronic focus DMX channel value, does suitable distance
Power down	The lamp maybe arrived end of using life, should change new lamp, and also check light source cleaning or not

**Note:** the maintenance should be done by the verified technician.

